



UPSTREAM ENGINEERING, LLC

"Providing Value Added Engineering Services"



Corporate Office
1505 Hwy 6 South, Suite 380
Houston, TX 77077
Phone: 281.531.0047 Fax: 281.531.8145

Corporate History

- Established in 2002, Focused on Providing Engineering and Project Management Services to the Offshore Oil & Gas Sector
- Privately Held Company Led by Working Principals; Ronnie Smith and Don Ybarra Both with Over 30 Years Experience
- Expertise in Offshore Platforms and Topsides
- Licensed Provider of SeaHorse Platforms
- Extensive International Experience
- Flexible Contracting Strategy; E, EP, EPCM or EPC

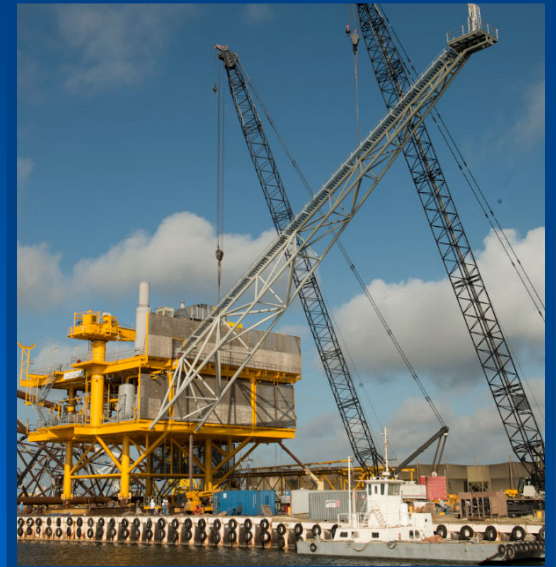
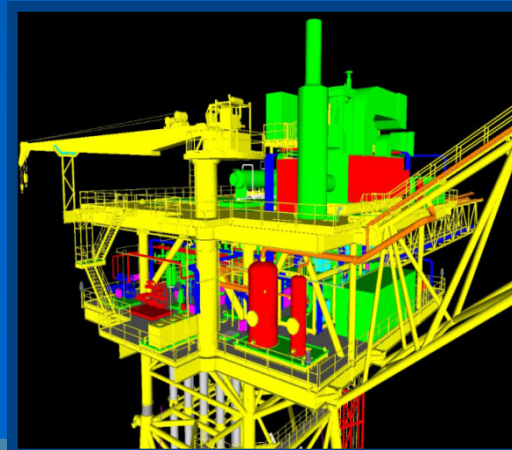
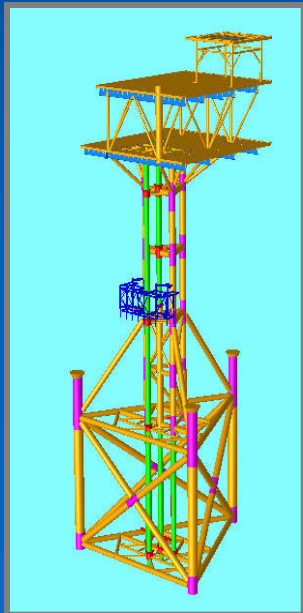

Where We Provide Our Services

 *Opportunities for Adding the
Greatest Value to a Project* 

Front End Engineering Design

- Concept Selection Studies
- Cost Estimates
- Project Planning
- Preliminary Engineering

**Project
Management**

**Detailed
Engineering and
Design Drafting**

Procurement

**Construction
Management**

Areas of Expertise-General

Engineering Disciplines

- Process
- Mechanical
- Instrumentation
- Structural
- Civil
- Pipeline
- CAD
- Scheduling/Cost Control
- Procurement
- Document Control

Expertise

- Concept Selection
- Project Management
- Offshore Platforms
- Production Facilities
- Subsea Pipelines
- Jackets/Decks
- Quarters Modules
- Compression Platforms
- Commissioning/Startup

Previous Experience



Proven Platform Delivery Experience



CFBX – 10 Months



WFB – 8 Months



BAGRE-C -9 Months



BOLONTIKU- B - 8 Months



MAY C – 8 Months



MAY DL-1 – 6 Months

ENI MEXICO

MIZTON FIELD DEVELOPMENT



- The MIZTON WHP Platform :
 - Unmanned Satellite Production Facility
 - 106' W.D.
 - Conventional Piled, 4-Leg Platform
 - 12 conductors
 - 60,000 bopd
 - 12 MMSCFD
 - Three Primary Deck Levels
 - Boat Landing
 - Emergency Quarters
- The Main deck was designed to accommodate coiled tubing unit
- The Cellar deck was designed for the production equipment.
- Export Pipeline is 10" to an onshore separation facility
- Phase 2 production will flow to FPSO
- MIZTON is planned to be the first platform installed offshore Mexico by an IOC.

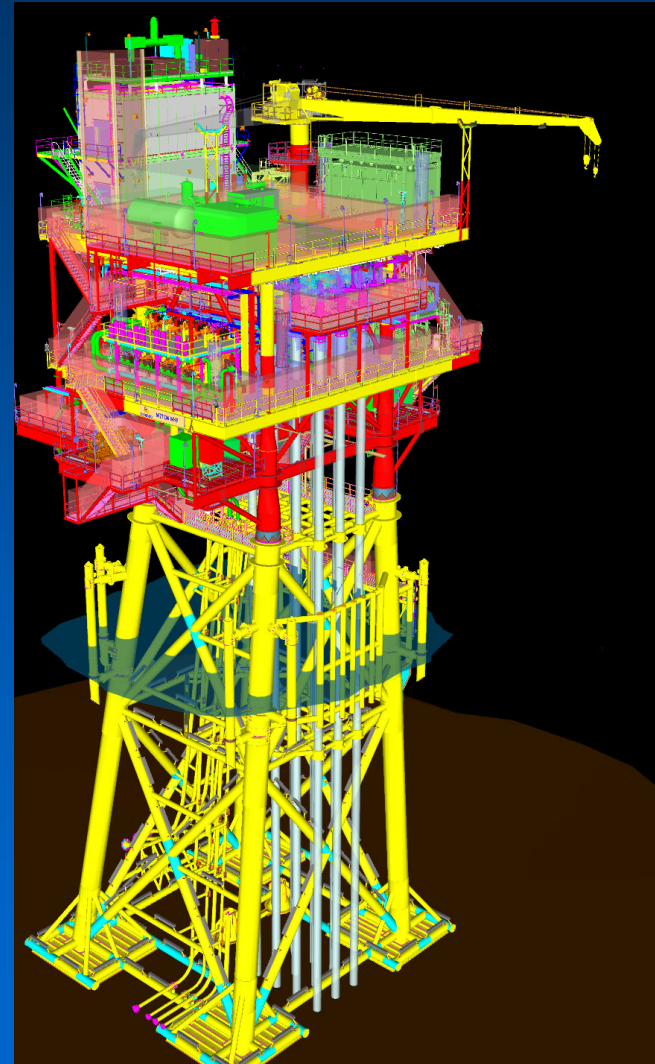

POKOCH and ICHALKIL FIELD DEVELOPMENT



- Upstream Engineering performed the Concept Select Study and is the Owners' Engineer for the EPCIC contract.
- UE developed the EPCIC ITT scope of work
- Project SOW is for two unmanned wellhead platforms; ICHALKIL and POKOCH tied back to the TUMUT platform.
- UE is currently designing both jacket structures in order to procure jacket material early.
- Both platforms are:
 - Unmanned Satellite Production Facility
 - Conventional Piled, 4-Leg Platform
 - 6 conductors
 - 51,000 BOPD total production
 - Two Primary Deck Levels
 - Boat Landing
 - Helideck
 - Emergency Quarters
- The Main deck is designed to accommodate coiled tubing unit
- The Cellar deck is designed for the production equipment.
- Export Pipelines are 16" x 7.3 km and 24" x 11.7 km pipelines to the TUMUT Platform



SERCAN FIELD DEVELOPMENT



- The SERCAN WHP Platform :
 - 340' W.D.
 - Conventional Piled, 4-Leg Platform
 - 6 conductors
 - 250 MMSCFD
 - Two Primary Deck Levels
 - Unmanned Satellite Production Facility
 - Boat Landing
 - Helideck
 - Emergency Quarters
- The Main deck was designed to accommodate coiled tubing unit
- The Cellar deck was designed for the production equipment.
- Export Pipeline is 14" x 2.4 km to the TOUCAN Platform
- The platform is currently being installed

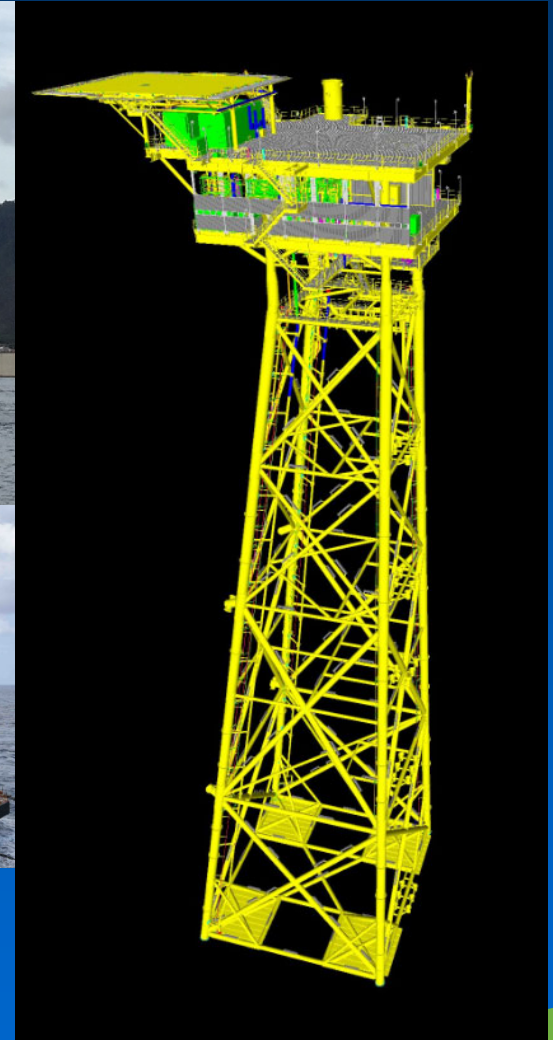

SERCAN FIELD DEVELOPMENT



Sercan Platform
EOG's 9TH Platform 25 July 2016

Previous Experience (Detailed Engineering)

BHP TRINIDAD ANGOSTURA QUARTERS STRUCTURAL DESIGN

- **Upstream scope of work consisted of Structural Design Services:**
 - 57 Persons
 - 4 Story Unit
 - 1150 ton lift



ARUP HUSKY WHITE ROSE WRCAD



Scope:

- Upstream working for ARUP provided the conceptual engineering and Pre-FEED engineering for the topsides portion of the Husky White Rose Wellhead Platform.

Project Description:

- Concrete Gravity Based Structure
- 20 Conductors for up to 40 wellheads
- Design Rates: 25,000 BOPD, 53 MMSCFD.

Platform Drilling Rig

- Platform is designed to accommodate a 5,500 ton winterized drilling rig that includes drillfloor substructure, mud tank package, liquids package, mud pump module, storage module, generator module, quarters/helideck module.

Platform:

- Drilling Deck 66M x 45M
- Mezzanine Deck 66M x 45M
- Middle Deck 66M x 45M
- Cellar Deck 45M x 66M
- 120 Persons Living Quarters
- Topsides includes well manifolds, multiphase meters, gas scrubber skid, seawater pump skids, firewater pumps, launcher/receivers for export pipelines

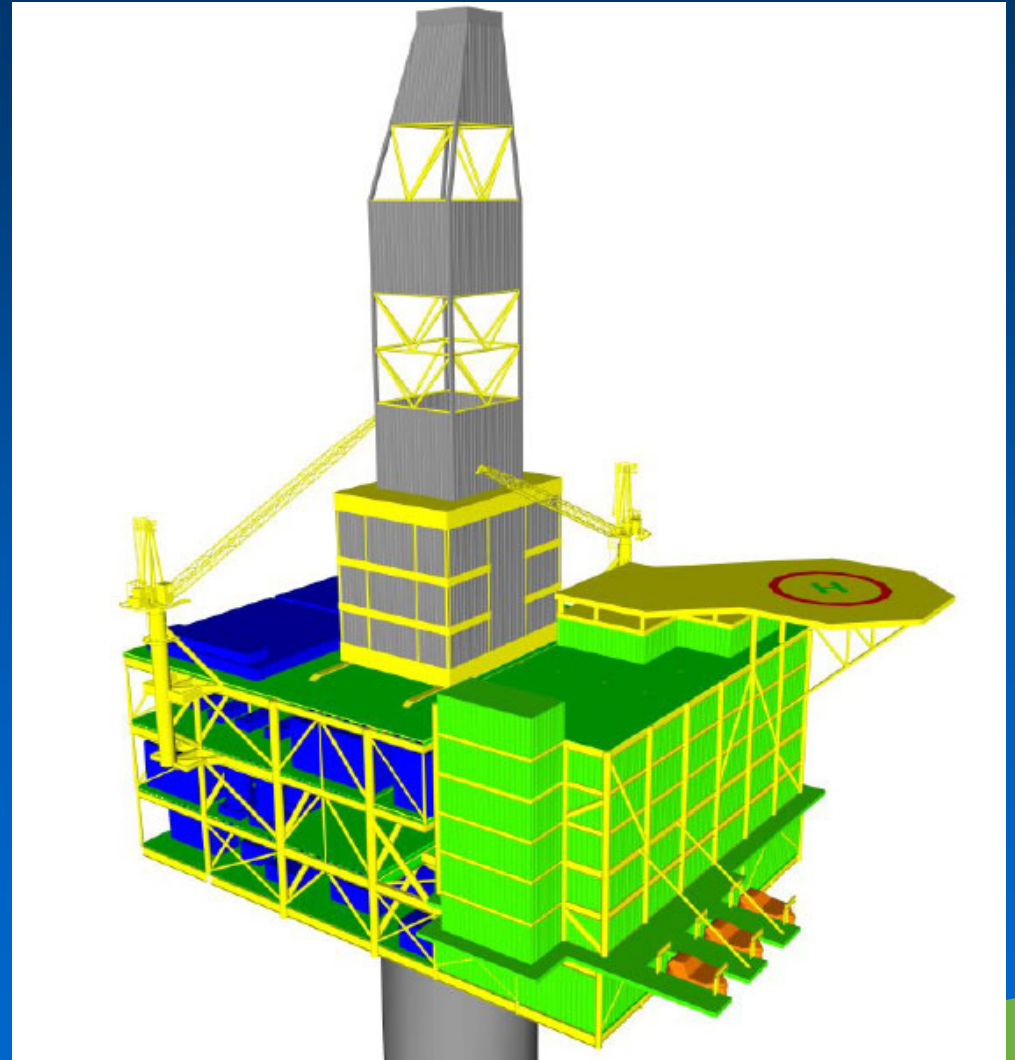

XUX-A DRILLING/PRODUCTION PLATFORM



Scope:

- Upstream is providing basic and detailed engineering and procurement support (vendor data review) for an EPC project. The projected topsides weight with rig equipment packages will be upwards of 8,000 ton topsides.

Project Description:

- Design Rates: 30,000 BOPD, 131 MMSCFD.

Platform Drilling Rig

- Platform is designed to accommodate a 5,500 ton modular self contained drilling rig that includes drillfloor substructure, mud tank package, liquids package, mud pump module, storage module, generator module, quarters/helideck module.

Platform:

- 8-leg Drilling and Production Platform, 2,500 ton deck lift weight,
- 165' x 115' drilling deck,
- 151' x 167' production deck, 18 wells slots (dual well bays). Conventional jacket and piled structure.
- Topsides includes well manifolds, test separator, gas scrubber skid, seawater pump skids, firewater pumps, launcher/receivers for 36" export pipeline, 24" incoming pipeline, 20" incoming pipeline and 10" gas lift line.

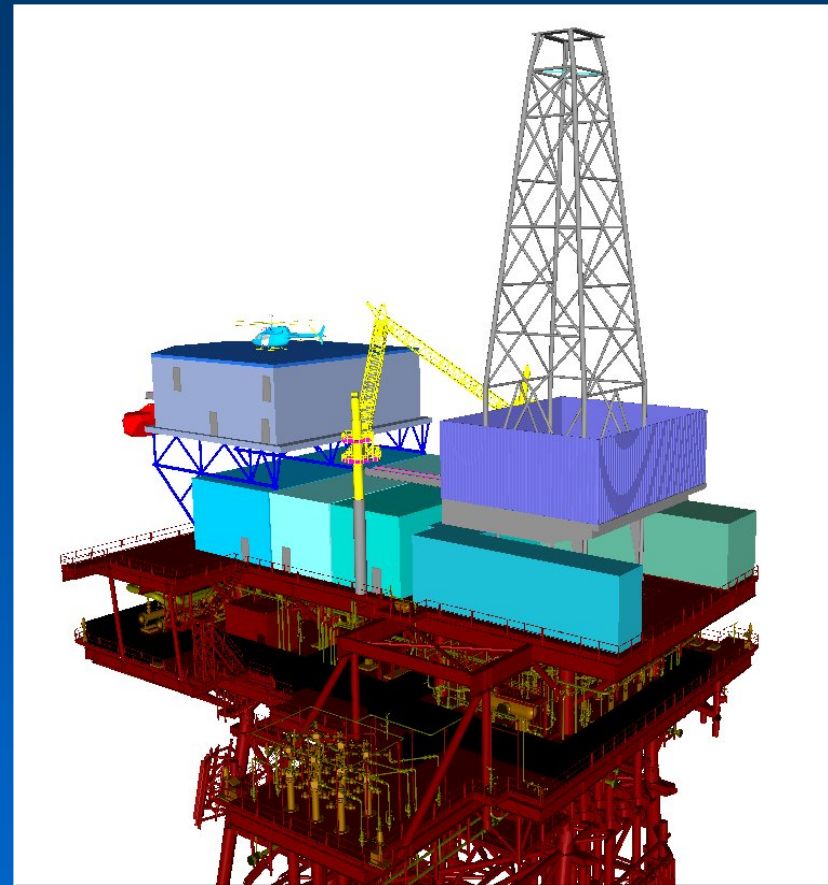

EBOK FIELD CFB WSS PLATFORM / CFBX WHP



- Central Fault Block Well Support Platform
- CFBX Wellhead Platform
- Bridge to MOPU



EBOK FIELD CENTRAL FAULT BLOCK EXTENSION



- The CFBX WHP Platform :
 - Conventional Piled, 4-Leg Platform
 - 12 conductors for up to 24 wellheads
 - 35,000 BOPD, 16 MMSCD
 - Two Primary Deck Levels
 - Unmanned Satellite Production Facility
 - Centaur 40 Solar Turbine
 - Surfer Boat Landing
 - Flare
 - Bridge to MOPU
- The Main deck was designed to accommodate coiled tubing unit
- The Cellar deck was designed for the production equipment.



EBOK FIELD WEST FAULT BLOCK PLATFORM



- **The West Fault Block Platform :**
 - **Conventional Piled, 4-Leg Platform**
 - **20 well slots**
 - **35,000 BOPD, 16 MMSCD**
 - **Two Primary Deck Levels**
 - **Unmanned Satellite Production Facility**
 - **Boat Landing**
 - **Helideck**
- **The Main deck was designed for a modular platform drilling rig**
- **The Cellar deck was designed for the production equipment.**
- **The project duration was 8 months from start of design to loadout.**



OML 112

OKORO FULL FIELD DEVELOPMENT WHP #2



- The OKORO WHP #2 Platform :
 - Conventional Piled, 4-Leg Platform
 - 12 conductors for up to 24 wellheads
 - 50,000 BOPD, 45 MMSCFD
 - Two Primary Deck Levels
 - Unmanned Satellite Production Facility
 - Bridge to MOPU
- The Main deck was designed to accommodate coiled tubing unit
- The Cellar deck was designed for the production equipment.
- Export Pipeline is 12" 60 km pipeline to IMA Terminal
- The platform is planned to be installed in Spring 2015

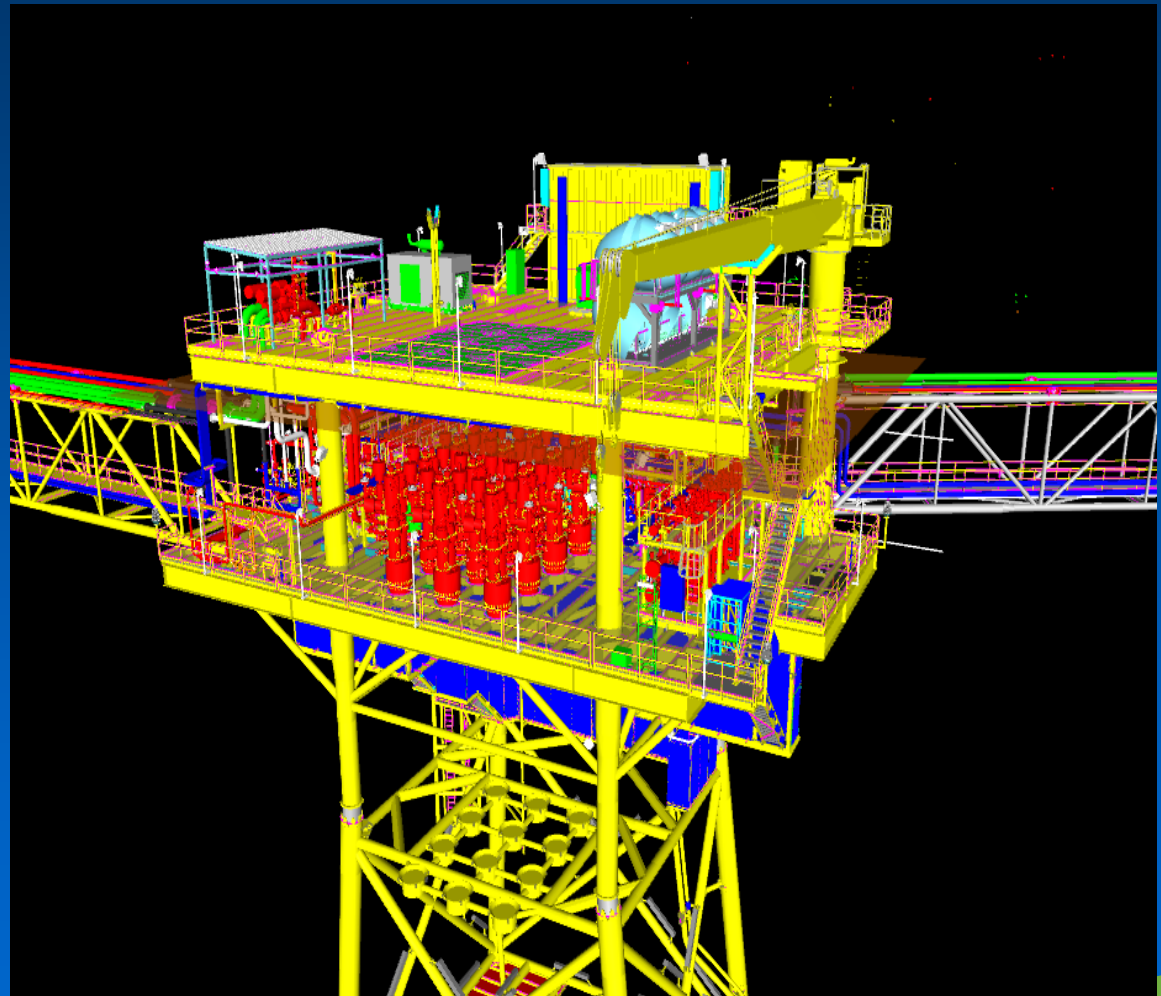

OML 67

OKWOK FIELD DEVELOPMENT



- The OKWOK WHP Platform :
 - Conventional Piled, 4-Leg Platform
 - 16 conductors for up to 32 wellheads
 - 40,000 BOPD, 25 MMSCD
 - Two Primary Deck Levels
 - Unmanned Satellite Production Facility
 - Surfer Boat Landing
 - Ramp to MOPU
- The Main deck was designed to accommodate coiled tubing unit
- The Cellar deck was designed for the production equipment.
- Export Pipeline is 12" 14 km pipeline to EBOK
- The platform is planned to be installed in Spring 2015

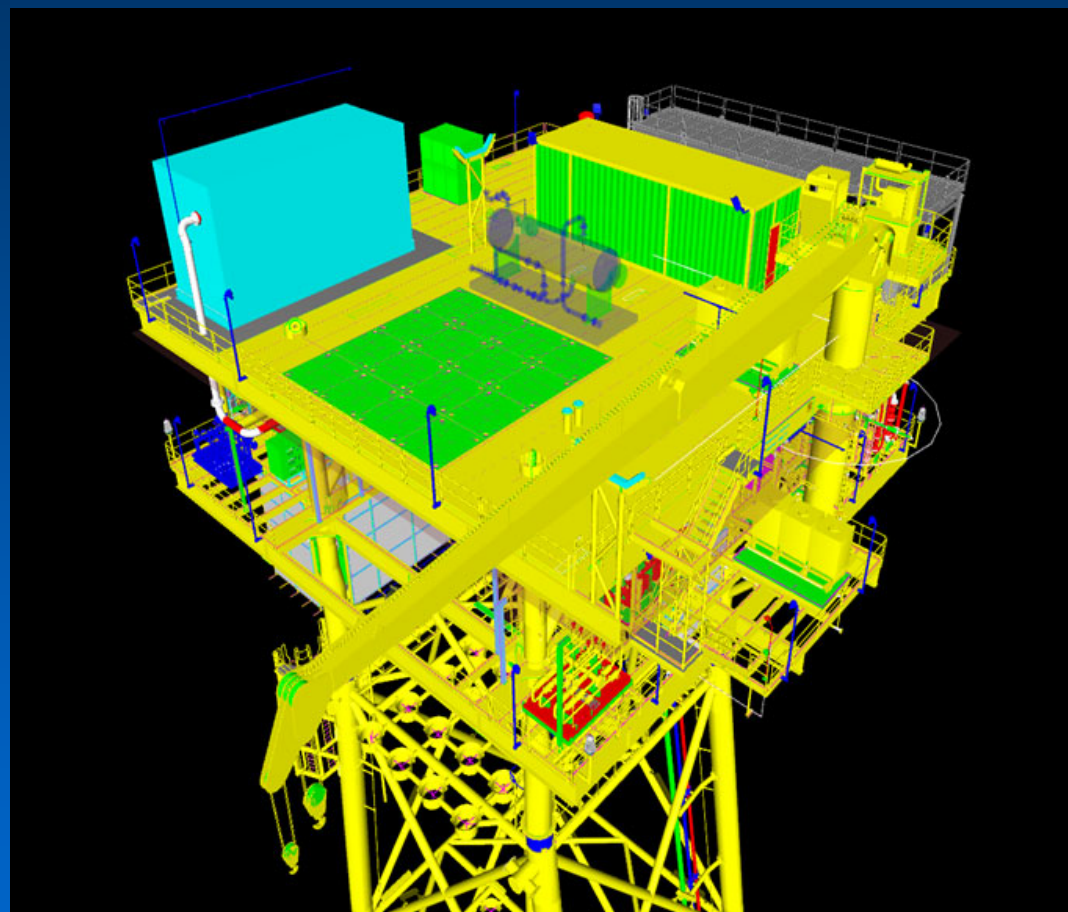

ENAP SIPETROL AM-2 MODULES REBUILD



enap sipetrol

- CLIENT ENAP SIPETROL
- PROJECT SCOPE OF WORK : EPC
- PROJECT MANAGEMENT, ENGINEERING, PROCUREMENT AND FABRICATION FOR MODULES:
 - HELIDECK
 - QUARTERS MODULE
 - CONTROL MODULE
 - GENERATION MODULE



SeaHorse Platforms EPC

SeaHorse Platform Partners

- SEAHORSE was the Pioneer in the Minimal Platform Solutions Market
- SEAHORSE designs are based on fit for purpose GOM Engineering
- SEAHORSE is the most successful Minimal Platform Concept used in the North Sea
- Upstream Engineering is the exclusive provider of SEAHORSE Platforms for North & South America and West Africa



PSD SEAHORSE PLATFORM PARTNERS, LTD.

TEMBIKAI CENTRAL PRODUCTION PLATFORM



- EPCIC Contract
- SeaHorse III Platform
- 3 Well Slots for 6 Wells
- 70 M Water Depth
- Topsides includes; separation/water treating, power generation, etc. with production transported via pipeline to FSO
- CPP Topsides
 - 10,000 BOPD
 - 10 MMSCFD
 - 1000 BWPD



PEMEX Exploración - MAY DL-1



- **Upstream Scope of Work consisted of an EPC contract:**
 - SSCI Fabrication Sub- Contractor
 - Direct Assignment Contract
 - ITS/PEP contract holder
 - Project Completed in 6 months
 - Platform Installed by PEP



PEMEX Exploración & Producción



- **Upstream Scope of Work is an EPC contract:**

- SSCI Fab Sub-Contractor
- Direct Assignment Contract
- ITS/PEP contract holder
- Project Schedule 8 months



MAY-C

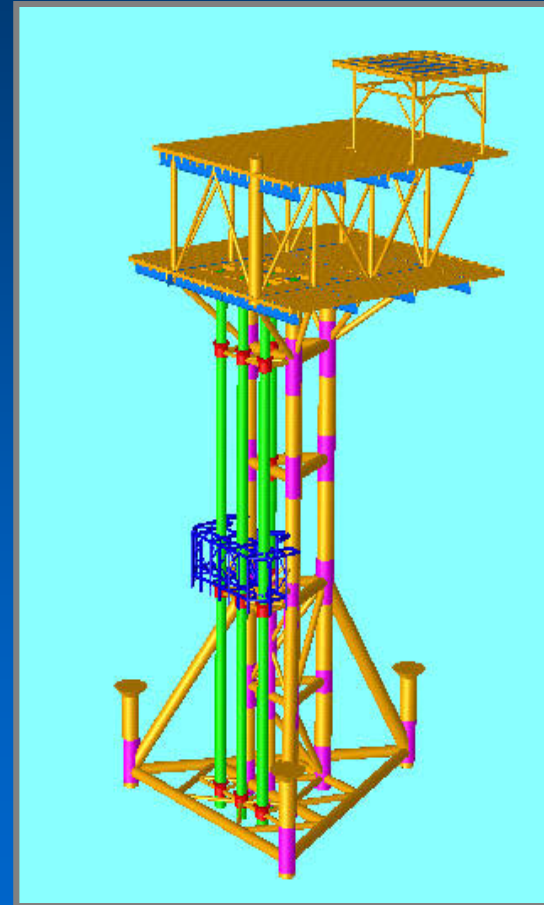

PEMEX Exploración & Producción



- Upstream Scope of Work is an EPC contract:
 - SSCI Fab Sub-Contractor
 - Direct Assignment Contract
 - ITS/PEP contract holder
 - Project Schedule 8 months



BOLONTIKU-B



PEMEX Exploración & Producción



- Upstream Scope of Work is an EPC contract:

- SSCI Fab Sub-Contractor
- Direct Assignment Contract
- ITS/PEP contract holder
- Project Schedule 9 months

BAGRE - C



Upstream Clients

- Addax Petroleum
- Afren Resources
- Anadarko Petroleum Company
- Atlantia Resources
- BP Trinidad & Tobago
- BP Americas
- Burlington Resources
- BPZ Energy, Inc.
- Cabot Oil & Gas
- Chevron
- ConocoPhillips
- ENAP Sipetrol
- EOG Resources Trinidad & Tobago
- El Paso Production
- ENI Mexico
- ENAP Sipetrol
- Fieldwood Mexico
- GoMex
- Gryphon Exploration
- Hunt Oil Company
- Helis Oil
- Marathon Petroleum Co.
- Mariner Energy
- National Gas Company of Trinidad
- Noble Energy
- Oiltanking, Houston L.P.
- Oriental Energy Resources Ltd.
- Pemex Exploración y Producción
- Popham Walters/TOE/BHP
- Palace Exploration
- Phoenix Exploration
- Probe Resources
- Spinnaker Exploration, LLC
- State Service (PetroCorp)
- Swift Energy Operating Co.
- Vaalco Gabon (Etame) Inc.
- Vestigo Petroleum
- Walter Oil & Gas
- W & T Offshore
- Williams
- Yuma Petroleum